

[inside/out]



2011

New England School of Congregational Development

November 4-5, 2011

Grace Chapel • Lexington, MA

Event Program

<i>Welcome</i>	1
<i>Schedule</i>	2
<i>Presenters</i>	3
<i>Workshop Session 1 Offerings</i>	9
<i>Workshop Session 2 Offerings</i>	12
<i>Workshop Session 3 Offerings</i>	15
<i>Workshop Session 4 Offerings</i>	18

Sponsors

<i>Camp Aldersgate</i>	21
<i>Preacher's Aid Society</i>	22
<i>United Methodist Federal Credit Union</i>	22
<i>Clothes for a Cause!</i>	23
<i>United Methodist Foundation of New England</i>	24
<i>Rethink Church</i>	25

Welcome!

Just then a lawyer stood up to test Jesus.

“Teacher,” he said, “what must I do to inherit eternal life?”

He said to him, “What is written in the law? What do you read there?”

He answered, “You shall love the Lord your God with all your heart, and with all your soul, and with all your strength, and with all your mind; and your neighbor as yourself.” And he said to him, “You have given the right answer. Do this, and you will live.”

— Luke 10: 25-28

Simple. Love God. Love neighbor. This is living.

Do these things, and then you will live the life for which you were created. It’s the kind of love that starts inside and moves out. Or starts outside and moves in. Or turns things inside out and upside down. Really, it’s the kind of love that changes everything.

This year’s School of Congregational Development is designed to challenge you and inspire you to live out Jesus’ words to love – love God and love neighbor – in a way that turns you, your church, and your community

inside out — or maybe outside in. Guess it all depends on where you begin.

With both plenaries and workshops that are designed to enrich and inspire you on the “inside” as well as challenge and motivate you to move “outside,” this event has been creatively and prayerfully designed to equip you and your church for ministry in the 21st century. We fully expect that it will send you back to your community ready to “love God and love neighbor” from the Inside Out.

The School of Congregational Development for the United Methodist Church in New England

Friday-Saturday, November 4-5, 2011

Grace Chapel, Lexington, MA

www.newenglandschool.org

www.neumc.org/cd

Friday, November 4

9:00 - 11:00 am	Pre-Conference Intensives (optional)	
11:30 am	Lunch for Pre-Conference participants and team (on site)	Fellowship Hall
12:00 - 1:00 pm	Registration	
1:00 pm	Plenary 1: Margaret Fienberg	Sanctuary
2:30 pm	Workshop Session 1	Upper Level
4:00 pm	Workshop Session 2	Upper Level
5:30 pm	Dinner (on site)	Fellowship Hall
7:00 pm	Evening Worship Celebration: Rene Perez preaching	Sanctuary

Saturday, November 5

8:00 am	Early morning	
9:00 am	Plenary 2: Jorge Acevedo	Sanctuary
10:30 am	Workshop Session 3	Upper Level
11:45 am	Lunch (on site)	Fellowship Hall
1:00 pm	Workshop Session 4	Upper Level
2:30 pm	Plenary 3 and Worship: Jorge Acevedo	Sanctuary

Ongoing

Registration and Information	Main Foyer
Cokesbury Book Store	Chapel
Childcare	Lower Level
Prayer Chapel	Upper Level
Displays	Upper Level Foyer

Spiritual Direction

Individual appointments for personal spiritual direction are available throughout the event. Please sign up at the Registration table.

Jorge Acevedo*Saturday Keynote Speaker*

Jorge Acevedo is the lead pastor of Grace Church, a multi-site United Methodist congregation in Cape Coral, Florida. Over the past thirteen years, this church has grown in its weekend attendance from 400 to over 2600. Grace Church has one of the largest and most effective recovery ministries in America, with over 800 people involved in weekly recovery ministries. Born in Puerto Rico, Jorge moved to the US at the age of four months. He and his wife, Cheryl, have two sons, Daniel and Nathan, and two beautiful grandchildren.

Margaret Feinberg*Friday Afternoon Speaker*

A popular speaker at churches and leading national conferences, Margaret Feinberg has written more than two dozen books and Bible studies including the critically-acclaimed *The Organic God*, *The Sacred Echo*, *Scouting the Divine*, and their corresponding DVD Bible studies. She is known for her relational and invitational teaching style. Margaret currently lives in Morrison, Colorado, with her 6'8" husband, Leif. When she's not writing or traveling, she enjoys anything outdoors, lots of laughter, and their superpup, Hershey.

John Edgar*Workshop Leader*

John Edgar is the founding pastor of the remarkably diverse United Methodist Church for All People, and the executive director of its sister organization, Community Development for All People located in the inner city of Columbus, Ohio. An ordained pastor for over 30 years, he has previously served as a district superintendent and dean of the cabinet in the West Ohio Conference.

Kelley Hartnett*Workshop Leader*

Kelley Hartnett is the former Director of Communications for Morning Star Church (MSC) in O'Fallon, Missouri, one of the 100 largest United Methodist Churches in the country. She was a part of the church's Strategic Leadership Team, led the communication efforts for two major capital initiatives, directed a website redevelopment effort, and launched the church into the social media space. She's currently coming to grips with the idea that neither sarcasm nor procrastination is actually a spiritual gift, she's a big fan of authenticity, and she believes words matter.

Bener Agtarap*Pre-Conference Intensive Leader*

Originally from Manila, Philippines, Bener Agtarap has a passion for transforming existing congregations for planting new churches. He contributed in giving birth to a new district and an annual conference in Cavite, Philippines, and in creating the culture of church multiplication in the Philippines. An ordained Elder from the Wisconsin Annual Conference, Bener has served as a local pastor, new church planter, and district superintendent. Currently he is serving as a New Church Strategist for Path 1 and New Church Starts Division of the General Board of Discipleship.

Rene Perez*Friday Evening Speaker*

Newly appointed as the District Superintendent of the Central Massachusetts District, Rene Perez brings experiences as a pastor of multicultural congregations, most recently Lititz UMC in Lititz, PA. He has also served as director of congregational development for the Eastern Pennsylvania Conference, and as consultant with the National Plan for Hispanic/Latino Ministries with the General Board of Discipleship and the General Board of Global Ministries.

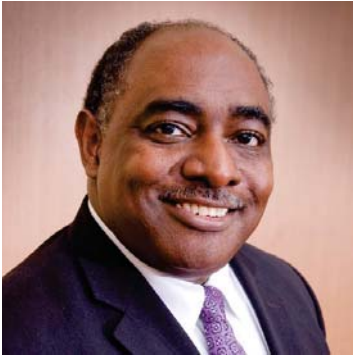
Kirk Byron Jones*Workshop Leader*

Kirk Byron Jones is the acclaimed author of such books as *Rest in the Storm: Self-Care Strategies for Clergy and Other Caregivers*; *Addicted to Hurry: Spiritual Strategies for Slowing Down*; and *The Jazz of Preaching: How to Preach with Great Freedom and Joy*. A Baptist pastor for more than twenty years, he is an adjunct professor at Andover Newton Theological School and Boston University School of Theology, and he preaches and teaches at churches, schools and conferences throughout the country.

David Abbott*Saturday Morning: Rightside Up*

David Abbott currently serves as the District Superintendent of the New Hampshire District. Previously he served for 14 years as the pastor of the Belfast United Methodist Church. During that time, the faith community grew from 50 to almost 200 in worship and built a new facility to better serve the area communities. David has a passion for church transformation and smaller membership churches. The focus of his doctoral project was “restoring the self-esteem of smaller membership churches through district conferencing.” David, and Lisa, his wife of 28 years, have two sons: Chris (medical school) and Matt (Lt in US Army).

Garrison Doles*Musical Guest*

Singer/ songwriter Garrison Doles calls himself “a broken shard of sea glass that washed up on the beach -- shattered and jagged and tossing in the ocean, tumbling against the sandpaper bottom until it rolled out smooth and hard and not quite transparent.” He has recently won major songwriting competitions in North Carolina, Texas, Florida and Massachusetts and he’s on the move, touring nationally and performing at all the best festivals, coffeehouses and house concerts. We look forward to welcoming him to this year’s School of Congregational Development!

Shelley and Mike Tworoger*Music Leaders*

Shelley & Mike Tworoger are currently the musicians for Connexion, a newly redeveloping United Methodist faith community in Somerville, MA. When they're not making music -- Shelley on the keyboard and vocals, and Mike on bass, guitar, and percussion -- they're often in the lab. Shelley conducts cancer research at Brigham & Women's Hospital and teaches at Harvard Medical School, and Mike is part of a research team in a lab in Cambridge, MA.

My plenary notes for Margaret Feinberg

Key ideas:

Action Box

2 ideas that I learned from this plenary that will change my ministry and leadership:

2 next steps to implementing what I've learned:

2 people I need to tell about these ideas:

My prayer for God's help and vision in putting these ideas into action:

My plenary notes for Jorge Acevedo

Key ideas:

Action Box

2 ideas that I learned from this plenary that will change my ministry and leadership:

2 next steps to implementing what I've learned:

2 people I need to tell about these ideas:

My prayer for God's help and vision in putting these ideas into action:

Session 1: Friday 2:30 pm

1A *Sacred Rhythms: Finding Our Center in Worship - Nisha Purushotham* **Room 204**

Meaningful worship experiences provide opportunities for quiet meditation, impassioned community expression, and heightened awareness of our deep connection to the global community. Experience how global percussion from Africa, Asia, and South America can immerse us in these distinct and inter-related forms of worship. The global percussion experiences shared in this workshop will be introduced in a way that can be replicated in any congregation.

1B *Learning to Live at a Sacred Pace - Kirk Byron Jones* **Sanctuary**

Based on his bestselling book, *Addicted to Hurry: Spiritual Strategies for Slowing Down*, Kirk Byron Jones will present practical spiritual strategies for combating the modern-day addiction to hurry.

1C *Developing a Creative Team for Worship Ministry - Steve Murray* **Room 205**

Worship is the first point of entry for many seekers. It is also the single greatest opportunity we have each week to reach and disciple our existing congregation. As both an opportunity for evangelism and discipleship, a well crafted, creative, engaging worship service is one of the most important things we do. Whether in a more traditional or more contemporary worship setting, a creative approach to worship, and particularly the message, that is team driven can bring a renewed vitality to the worship experience.

1D *Doing Together What We Can't Do Alone: Building Partnerships for Ministry - Jim McPhee* **Room 207**

This workshop will provide an overview of the rationale and foundations for shared ministry. We'll explore some basics for working with other congregations and/or community groups for effective ministry with our communities and the world.

1E *Inside Out of Control - Kelley Hartnett* **Room 202B**

In a zip-through-the-commercials culture, bullhorn-based marketing is no longer successful. In this session, Kelley will walk you through her top five "consider this" elements of an effective church communications plan and offer some practical resources, tips, and how-tos.

1F *Building Relationships with Persons Who Are Poor and Marginalized - John Edgar* **Room 208**

The most important aspect of the United Methodist priority on engaging in ministry with the poor is the word "with." This workshop will share best practices for using direct services to build strong relationships of mutuality with persons who are poor and marginalized. Participants will explore their capacity and affinity for this style of ministry.

1G *Rethink Church: Creating an Atmosphere of Welcoming - Jennifer Rodia, Rethink Church* **Room 202A**

Since 2001, churches all over the country have taken to heart the denomination's promise of "Open hearts. Open minds. Open doors." Welcoming resources and training have given churches new hope, new ideas and new challenges. Pastors have preached on the subject. Church councils have adopted vision statements reflecting the desire to live up to these words. Individual members have examined their hearts and minds to assess whether they can claim the promise as their own. During this time, careful analysis, soul searching and feedback from newcomers have challenged some of our churches and affirmed others. What's next? This workshop offers suggestions for sustaining a congregation's welcoming, inviting and discipling efforts to help your church live the promise of "Open hearts. Open minds. Open doors."

1H *Part Time Pastor/Full Life Church - Rachel Fisher*

Room 106

A chance to consider the historical context of parttime pastors and how it informs the church as we step into a hopeful, fruitful future. Rev. Fisher brings to bear her experience of nine years of vibrant part-time ministry in the NE Conference, encouraging discussion and practical application amongst the participants.

1I *Rediscovering Mission - Dan Randall, General Board of Global Ministries*

Room 105

What is Missions? For whom is it? To whom is it? A GBGM missionary invites you to explore fresh ways for your congregation to connect to UM missionaries and mission projects amidst our globalized, modernized, and technologized 21st Century world.

1J *Continuing the Conversation - Margaret Feinberg*

Room 203

Our Friday afternoon keynote speaker, nationally known author Margaret Feinberg, will invite workshop participants into conversation, engaging more deeply some of the concepts she explored in our first plenary session.

1K *Introduction to Church Planting - Rodney Smothers*

Room 206

In this introduction workshop, you'll learn the basics of why and how to plant a new faith community. New faith communities are the best way to reach new people who are interested in new things.

My Notes:

Workshop Title and Presenter:

Key ideas:

Action Box

2 ideas that I learned from this plenary that will change my ministry and leadership:

2 next steps to implementing what I've learned:

2 people I need to tell about these ideas:

My prayer for God's help and vision in putting these ideas into action:

Session 2: Friday 4:00 pm

- | | | |
|---|--|-------------------------|
| 2A | <i>Lift Every Voice and Sing: Global Song and Inclusive Worship - Nisha Purushotham</i> | <i>Room 204</i> |
| Learn global songs of praise, prayer, and justice from Africa, South America, and Asia which are accessible to all levels of musical ability. Get a taste of how global songs can be woven into various liturgical experiences including calls to worship, Scripture reading, prayers of the people, and the sacraments to empower congregational participation, engender a sense of belonging and enliven worship. | | |
| 2B | <i>How to Burn Bright Without Burning Out - Kirk Byron Jones</i> | <i>Room 202B</i> |
| Based on his newest book and Facebook page, Say Yes to Grace, Kirk Byron Jones will present seven ways to replace debilitating stress with dynamic energy. | | |
| 2C | <i>Developing a Creative Team for Worship Ministry - Steve Murray</i> | <i>Room 208</i> |
| Worship is the first point of entry for many seekers. It is also the single greatest opportunity we have each week to reach and disciple our existing congregation. As both an opportunity for evangelism and discipleship, a well crafted, creative, engaging worship service is one of the most important things we do. Whether in a more traditional or more contemporary worship setting, a creative approach to worship, and particularly the message, that is team driven can bring a renewed vitality to the worship experience. | | |
| 2D | <i>It's a Beautiful Day in the Neighborhood: Exploring Shared Ministry Models with Neighborhood Institutions - John Mueller</i> | <i>Room 207</i> |
| Using Trinity Church, Springfield, MA as a case study, participants will be invited to reflect upon their own local context and how their setting might be calling them into deeper community ministry by partnering with neighborhood institutions. Conversation will take place on how best to build these partnerships, potential pitfalls, and the benefits of investing in these types of relationships for ministry and mission. | | |
| 2E | <i>Friend Me! Social Media for the Church - Kelley Hartnett</i> | <i>Room 205</i> |
| We spend a good bit of energy trying to get people to come to us. What would happen if we were to find cost-effective, compelling, and contextual opportunities to meet people right where they are . . . through channels that have already captured their attention? In Friend Me!, Kelley will share the benefits of harnessing the power of Web 2.0 for the church, and she'll invite some honest conversation about the shadow side of social media. | | |
| 2F | <i>Building Relationships with Persons Who Are Poor and Marginalized - John Edgar</i> | <i>Sanctuary</i> |
| The most important aspect of the United Methodist priority on engaging in ministry with the poor is the word "with." This workshop will share best practices for using direct services to build strong relationships of mutuality with persons who are poor and marginalized. Participants will explore their capacity and affinity for this style of ministry. | | |

2G ***Rethink Church: Engage and Involve 18 - 34 Year Olds
in the Ministries of Your Church - Jennifer Rodia, Rethink Church*** **Room 202A**

This workshop provides an overview of the Rethink Church movement with opportunities to explore the journey from Igniting Ministry to Rethink Church, the transformation from “open” as an adjective to “open” as a verb, the biblical and theological foundations for the movement, target audience groups (their characteristics and needs), examples of how churches are creating engaging ministries within their communities, and resources to empower and equip every congregation to join the movement. Rethink Church has developed multiple resources to assist the local church and we’ll explore them here.

2H ***Part Time Pastor/Full Life Church - Rachel Fisher*** **Room 106**

A chance to consider the historical context of parttime pastors and how it informs the church as we step into a hopeful, fruitful future. Rev. Fisher brings to bear her experience of nine years of vibrant part-time ministry in the NE Conference, encouraging discussion and practical application amongst the participants.

2I ***Mission Involvement: Practical Steps to Grow Your Congregation
in Mission Support and Outreach - Dan Randall, General Board of Global Ministries*** **Room 105**

Whether your congregation already supports missions or has yet to support missions, this discussion-based workshop will help you generate practical ideas with which you can involve your congregation in missions in further and deeper ways.

2J ***Preaching the Full Gospel, Ziegler Preaching Award Recipient*** **Room 209**

We’ll look forward to reflecting on the task of preaching with one recently recognized for outstanding gifts for this task of ministry.

2K ***Church Planting Leadership - Rodney Smothers*** **Room 206**

In this workshop, you’ll be introduced to some of the core ideas in providing leadership systems for new faith communities, church parenting models and shared ministry resourcing.

My Notes:

Workshop Title and Presenter:

Key ideas:

Action Box

2 ideas that I learned from this plenary that will change my ministry and leadership:

2 next steps to implementing what I've learned:

2 people I need to tell about these ideas:

My prayer for God's help and vision in putting these ideas into action:

Session 3: Saturday 10:00 am

3A *Ministry with Urban Children - Patricia Pena*

Room 206

What is it anyway? Removing the “code for minority” mentality. How do we even start? Get out! Creative ideas to connect with the community (looking at different ministries in New England). Parents involvement: taking it to the next step. This workshop is intended to be interactive and contextual. Participants will create a small action plan for their settings.

3B *More than S’mores: Growing Disciples Through Camping Ministries - Jen Carpenter*

Room 209

In today’s busy world filled with technology, camp is a place where we can breathe, connect and rejuvenate in Creation. The wilderness of camp can be a great place to build community, grow teams, strengthen leadership skills, and connect with God. Come and discover all that outdoor ministry centers have become in today’s world. We will explore ways to utilize the physical space at camp while at the same time showing how camps have gone beyond s’mores and campfires and have become centers for youth & adult leadership development and resource centers to strengthen your congregational ministries.

3C *Turning Worship Inside Out - Lee Soto*

Sanctuary

This workshop will look at the essence, experience of Worship. Defining and describing worship, presence of God as a key concept, a picture and pattern of the worship experience; expectancy in worship. At the end of this workshop, the participant will gain a deeper understanding of the Biblical basis for worship; identify the importance of the presence of God in worship, and define and describe the essence of worship. They will gain a deeper understanding of the experience of worship, identify patterns of worship, and learn the importance of expectancy in worship.

3D *Continuing the Conversation - Jorge Acevedo*

Room 204

Our keynote speaker, Jorge Acevedo, lead pastor of Grace Church in Cape Coral, FL, will invite workshop participants into conversation, engaging more deeply some of the concepts he explored in our Saturday morning plenary session.

3E *Stewardship as Outwardly Visible Spiritual Discipline - The Faith & Money Ministry of the United Methodist Foundation of New England*

Room 208

What are the spiritual disciplines that strengthen our faithful stewardship of God’s good gifts? Granted, John Wesley did not include faithful stewardship in his list of spiritual practices, but his writings clearly affirm stewardship. Year Round Stewardship includes personal and congregational choices and disciplines that invite intentional assessment and growth. Learn how generosity and growth in giving our time, talent and treasure connect us to God’s stewardship plan. Rev. Jim Mentzer, UMFNE President and Bonnie I. Marden, UMFNE Development Associate, will lead this workshop.

3F *Building a Front Porch to the Kingdom of God - John Edgar*

Room 202B

This workshop will explore strategies by which diverse multi-class congregations can build a front porch to the kingdom of God in their own communities. Emphasis will be placed on asset based community development and the value of embracing the divine economy of abundance. Specific examples will be shared about developing partnerships for ministry with other churches, community organizations, foundations, and government entities.

3G ***Impact Workshop #1: "Impact Community: How Rethink Church is Changing Lives" - Jennifer Rodia, Rethink Church*** **Room 202A**

Traditionally, the modern church thinks about ministering to its community. We speak in terms of the "churched" and the "unchurched." In this workshop, we will explore the unique opportunity UCom's "Impact Community" program provides churches. What if we identify good work to do WITH the community rather than FOR the community? What if we share the task and by that sharing, share ourselves with the very people we are hoping to influence? Come hear how and why some churches answered that question.

3H ***Tweets, Blogs and Websites, Oh My!: How to Begin Creating a Meaningful Community Presence on the Web - Mark Huber*** **Room 207**

You know the internet can be a great tool for ministry. You also know that your congregation could benefit from more digital engagement. Now what? This workshop will focus on the basics of getting your church presence up on the web. We'll look at the what to do, how to do it, and who can help you along the way.

3I ***Being Salt and Light: Congregations and Community Outreach - Steve Smith*** **Room 205**

Being the church in today's world means being present where people are physically, emotionally, and spiritually. It means being *relevant* for both the congregations and the communities around our church. In this workshop, Steve will share stories and lessons of "being church" from his experience as a pastor of smaller membership churches.

3J ***Growing God's Way: Using Natural Church Development to Grow Your Church - Rick McKinley*** **Room 106**

For any church interested in growing healthier, and thereby living more fully into its mission to love God, love neighbor, and transform the world, come to this inside look at Natural Church Development. We'll explore the principles behind it, and how your church can implement NCD. This workshop is intended for churches not already involved in the NCD process but would like to be. Suggest that you bring at least 2 people from your church.

3K ***Making the Church Visible - Alexx Wood*** **Room 203**

We work hard at making our churches welcoming for people that visit. But before people visit, they need to know something about you – even something as simple as how to find you. But making your church visible means more than just having clear signage in front of your building. It means finding multiple ways to communicate in multiple places – in your location, in the community, on the internet. This session will provide an overview and guidelines for your church to become an active and visible part of your community; to show not only where you are located, but to build interest and attract visitors by demonstrating elements of who you are and what you believe.

My Notes:

Workshop Title and Presenter:

Key ideas:

Action Box

2 ideas that I learned from this plenary that will change my ministry and leadership:

2 next steps to implementing what I've learned:

2 people I need to tell about these ideas:

My prayer for God's help and vision in putting these ideas into action:

Session 4: Saturday 1:00 pm

4A *Ministry with Urban Children - Patricia Pena*

Room 209

What is it anyway? Removing the “code for minority” mentality. How do we even start? Get out! Creative ideas to connect with the community (looking at different ministries in New England). Parents involvement: taking it to the next step. This workshop is intended to be interactive and contextual. Participants will create a small action plan for their settings.

4B *More than S’mores: Growing Disciples Through Camping Ministries - Jen Carpenter*

Room 210

In today’s busy world filled with technology, camp is a place where we can breathe, connect and rejuvenate in Creation. The wilderness of camp can be a great place to build community, grow teams, strengthen leadership skills, and connect with God. Come and discover all that outdoor ministry centers have become in today’s world. We will explore ways to utilize the physical space at camp while at the same time showing how camps have gone beyond s’mores and campfires and have become centers for youth & adult leadership development and resource centers to strengthen your congregational ministries.

4C *Worship is a Verb - Lee Soto*

Room 202B

This workshop will look at the Ministry of the Worship (The Worship Leader, the Team in Worship, the Ministry of Worship and Diversity in Worship). Will deal with the preparation, the rewards of team ministry; the role of the church leadership, worship leader, musicians and worshippers; and relationships in the team. Themes in worship; outlines for worship; creativity in worship; setting goals for worship; balance in worship; evaluation of worship; post worship selfevaluation; songs and worship; musical excellence in worship; control in worship and bringing change in worship. Integrating the audience: different age groups (children, teens, young adults, adults); generations (Boomers, GenXers, Millennials); commitment levels (seekers, believers); worship styles (traditional, contemporary; worship languages; modern, postmodern) and culture groups.

4D *Taking Mission from the Inside Out - Kevin and Joanne McNally*

Room 204

Is your church ready to move out of the sanctuary and into the world of mission? This workshop will provide practical steps you can take to make it possible for your congregation to experience the excitement of mission in your town, in New England, and in other countries.

4E *Personal Finance: Living Our Faith from the Inside Out - The Faith and Money Ministry of the United Methodist Foundation of New England*

Room 206

From our first paycheck to our final Will and Testament, what do our financial choices say about our faith? How does earning all we can and saving all we can prepare us to give all we can? Begin to align your life with your faith, from creating a financial plan to defining your legacy, today! Rev. Jim Mentzer, UMFNE President and Gary Melville, UMFNE Development Director, will lead this workshop.

4F *Born Again in Every Place - Pat Williams, Town and Country Ministry***Room 208**

This workshop will look at the Local Church Action Plan for the National Plan: "Born Again in Every Place". Touching briefly on the historical and biblical basis for the plan, the workshop will mainly focus on ways this is interpreted into our New England settings. Across the United States, many United Methodist town and country congregations effectively make disciples for Jesus Christ and creatively minister to their local communities and the world beyond. Imagine what will happen when these more than 20,000 in the United States renew and enlarge their visions of ministry, are supported and resourced for such work, and are affirmed in their importance to the church and its transformative work for the Kingdom of God. It is possible that the renewal and revival of the church will flow from town and country congregations to the rest of the world!

4G *Impact Workshop #2: "Impact Events: Planning for Success" - Jennifer Rodia, Rethink Church***Room 202A**

This workshop introduces participants to planning processes for Impact Events that have worked for different churches in the U.S. Participants will be guided through a workbook that helps churches explore the roles and activities to engage in before, during, and after the event so that the Impact Community Event becomes part of the overall life of a church's welcoming, ministry, and discipleship.

4H *Our Trustee's Cousin's Nephew's College Roommate Made Our Church a Website. Now What? - Mark Huber***Room 203**

You have a website. Maybe a Facebook page. Perhaps you even send out prayer requests via email. Now what? This workshop will look at effective ways to use your current website, social media presence, etc. to better connect and reach out digitally as a congregation.

4I *Being Salt and Light: Congregations and Community Outreach - Steve Smith***Sanctuary**

Being the church in today's world means being present where people are physically, emotionally, and spiritually. It means being *relevant* for both the congregations and the communities around our church. In this workshop, Steve will share stories and lessons of "being church" from his experience as a pastor of smaller membership churches.

4J *Growing God's Way: Using Natural Church Development to Grow Your Church - Rick McKinley***Room 106**

For any church interested in growing healthier, and thereby living more fully into its mission to love God, love neighbor, and transform the world, come to this inside look at Natural Church Development. We'll explore the principles behind it, and how your church can implement NCD. This workshop is intended for churches not already involved in the NCD process but would like to be. Suggest that you bring at least 2 people from your church.

3K *Making the Church Visible - Alexx Wood***Room 207**

We work hard at making our churches welcoming for people that visit. But before people visit, they need to know something about you – even something as simple as how to find you. But making your church visible means more than just having clear signage in front of your building. It means finding multiple ways to communicate in multiple places – in your location, in the community, on the internet. This session will provide an overview and guidelines for your church to become an active and visible part of your community; to show not only where you are located, but to build interest and attract visitors by demonstrating elements of who you are and what you believe.

My Notes:

Workshop Title and Presenter:

Key ideas:

Action Box

2 ideas that I learned from this plenary that will change my ministry and leadership:

2 next steps to implementing what I've learned:

2 people I need to tell about these ideas:

My prayer for God's help and vision in putting these ideas into action:

Are you ready to take your ministry to new Heights?

Let us help you reach higher in:

Worship Outreach
Children's Ministry
Family Ministry
Volunteer Training
Confirmation Retreats
Leadership Development
Congregational Outreach
VBS Teams
Offsite Day Camps
Nature Programs
Safe Ministry Training
Community Building
Retreat Weekends
Creation Care
Mission Projects
Team Building
Retreats
Spiritual Renewal



We're here to help!

Camp Aldersgate

grow@campaldersgate.com

401-568-4350



For more info contact:

Executive Director Jenn Becker Carpenter, M.A.



**United Methodist
FEDERAL CREDIT UNION**

United Methodist Federal Credit Union welcomes the attendees of the 2011 New England School of Congregational Development!

UMFCU is your full service financial institution, serving United Methodists within the New England UM Conference. Your local office is located in Westbrook Maine. You may contact your local office at 207-591-6449 or our headquarters at 800-245-0433.

We offer fine products and services for individuals, United Methodist churches and affiliated United Methodist organizations. We invite you to visit our website at www.umfcu.org to see the multitude of financial products and services available to you.

We look forward to you stopping by our table and visiting with Donna Fowlie during the conference.

Is your church considering a capital campaign?

Preachers' Aid Society would love to help!

For more information contact:

Kim Tisdale

Director of Development

(617) 874-6300

ktisdale@preachersaid.org

OR visit us online at

www.preachersaid.org

and click on ***Because They Serve***

Please, stop by and visit us

in the Lower Lobby. Just ask about

Campaign Partnership Opportunities.

BECAUSE THEY SERVE

An Initiative for our faithful pastors

By the Preachers' Aid Society





United Methodist Foundation of New England

10 Bricketts Mill Road ♦ PO Box 370 ♦ Hampstead NH 03841

ph: 800-595-4347 ♦ fx: 866-231-5921

email: info@umfne.org ♦ website: www.umfne.org

Our Vision:

A photograph of a white lighthouse with a red top, situated on a rocky shore next to a red building. The scene is set against a cloudy sky and a body of water.

*Christ-Centered Living
Christ-Centered Giving*

THE UNITED METHODIST FOUNDATION OF NEW ENGLAND

PARTNERING WITH CHURCHES - GROWING CONGREGATIONAL GENEROSITY

- INVESTMENT WITH SOCIAL PRINCIPLES
- CAPITAL CAMPAIGN CONSULTING
- PROVIDE PLANNED GIVING SERVICES
- CUSTOMIZED LENDING SOLUTIONS
- PROMOTE YEAR-ROUND STEWARDSHIP
- INNOVATIVE GRANT MINISTRY

TO LEARN MORE OUR SERVICES & RESOURCES, VISIT OUR WEBSITE

WWW.UMFNE.ORG

Copyright © 2009 Crescendo Interactive, Inc. IN1108-127 Photography by Tracy R. Olson



HOPE CHANGES EVERYTHING.

YOUR WORLD...

YOUR LIFE...

YOUR RELATIONSHIP WITH JESUS.

This Lent, Rethink Church invites you to take your church on a 7-week Journey to Hope. We'll travel with Jesus to the cross and discover the Hope that can be found in the midst of life's most difficult circumstances.

A JOURNEY TO HOPE will inspire people to reflect on Jesus' experiences on the path to the cross in new ways. It will encourage them to see to real life situations with fresh eyes. And it will challenge people to interact with God no matter their "mile marker" in life.

ORDER BY CALLING **1-888-346-3862**
or go to WWW.UMCOM.ORG/RETHINKSERIES



Open hearts. Open minds. Open doors.

The people of The United Methodist Church®

RETHINKCHURCH®

Floorplan

Grace Chapel

59 Worthen Road
Lexington MA
www.grace.org

Registration & Information

Main Level Foyer

Plenaries & Worship

Sanctuary

Workshops

Upper Level

Meals

Fellowship Hall

Cokesbury Book Store

Chapel

Displays

Upper Level Foyer

Prayer Chapel

Upper Level

Childcare

Lower Level

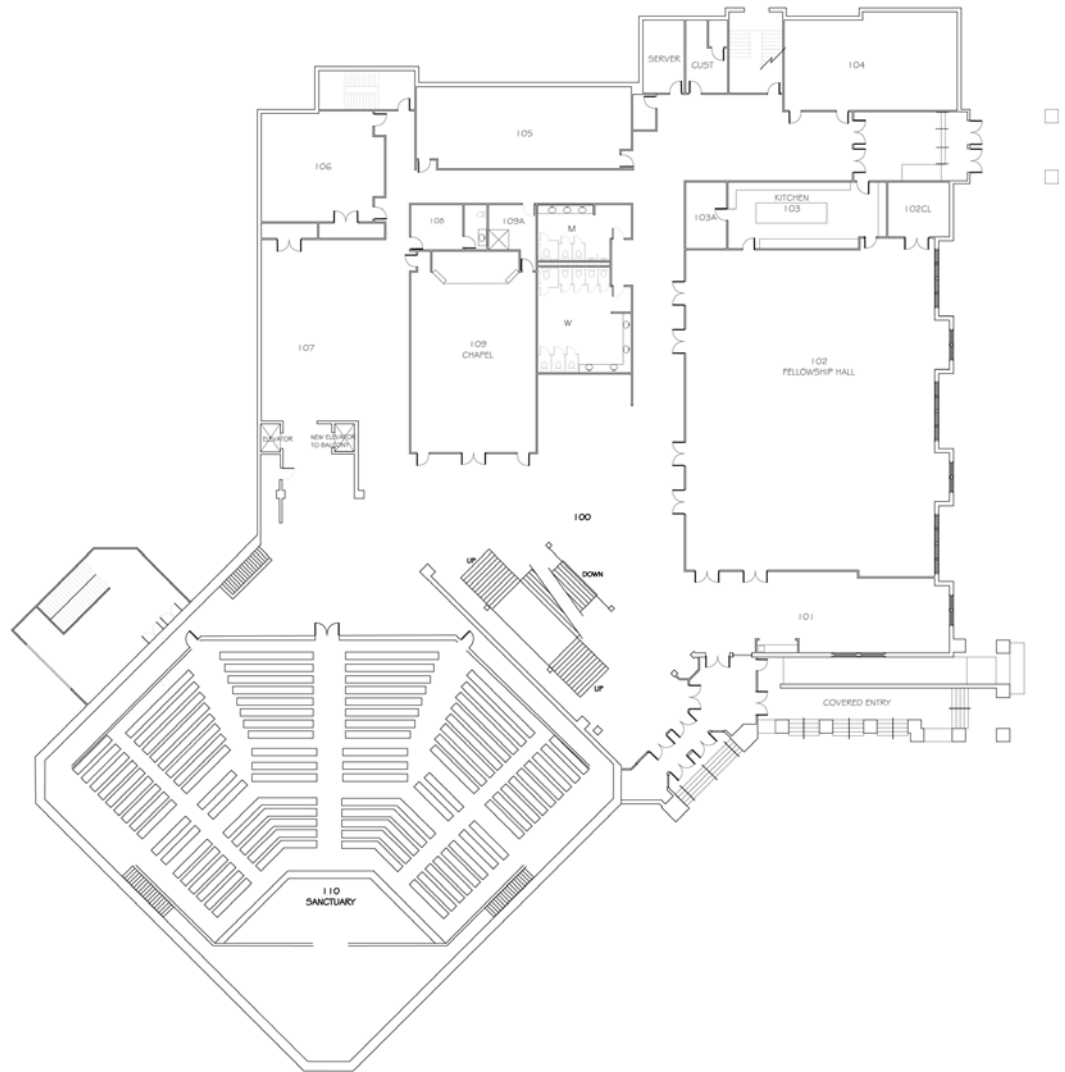

Block your calendar for next year's New England School of Congregational Development:

November 16-17, 2012

www.NewEnglandSchool.org

Get updates, resources and follow-up on growing your church at:

www.neumc.org/cd

www.facebook.com/NEUMChurches